

Courses of Little Juniata
from the N.O.

- N 38 W 86
- N 54 W 40
- N 21 W 61
- N 49 W 196
- NORTH 11
- N 19 E 26
- N 12 W 12
- N 18 W 40 to the N Maple
472

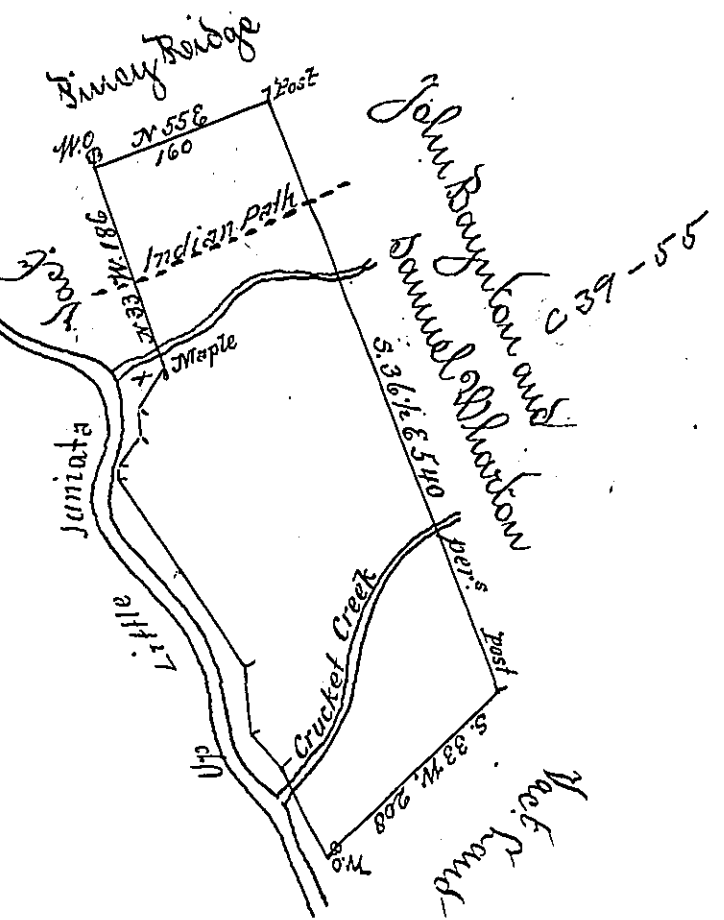

A Draught of a Tract of Land situate at the Forks or Mouth of Cricket Creek and on the Road or Indian path leading from Frankstown to the Bald Eagles nest in the County of Cumberland, containing six hundred and seventy three Acres and the usual allowance of six acres per Sect for Roads &c surveyed for John Baynton and Samuel Wharton in pursuance of a Warrant dated the 28th day of July 1766—

John Lukens Esq. Surveyr. Genl.

P. Richard Secy Dep^y Surveyr.

IN TESTIMONY that the above is a copy of the original remaining on file in the Department of Internal Affairs of Pennsylvania, made conformably to an Act of Assembly approved the 16th day of February, 1833, I have hereunto set my Hand and caused the Seal of said Department to be affixed at Harrisburg, this third day of September 1901.

James W. Fatta
Secretary of Internal Affairs.